

CDG Series

乾式單板電磁煞車器 Dry Single-plate Magnetic Brake

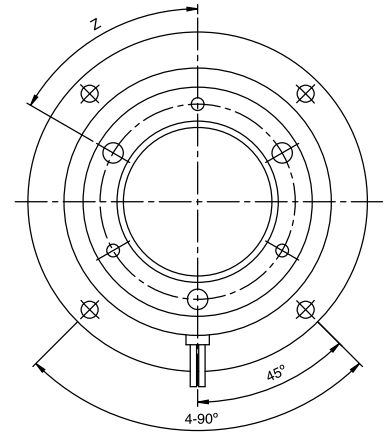
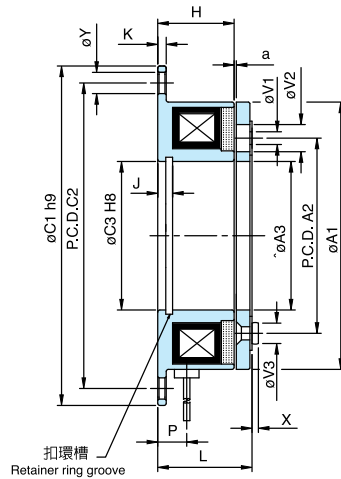

型號 MODEL		CDG0S6AA	CDG1S5AA	CDG2S5AA	CDG005AA	CDG010AA	CDG020AA	CDG040AA
靜摩擦轉距 [kgm](Nm) Static Friction Torque		0.55 (5.5)	1.1 (11)	2.2 (22)	4.5 (45)	9 (90)	17.5 (175)	35 (350)
動摩擦轉距 [kgm](Nm) Dynamic Friction Torque		0.5 (5.0)	1.0 (10)	2.0 (20)	4.0 (40)	8 (80)	16 (160)	32 (320)
功率 Power [24V](W) at 20°C		11	15	20	25	35	45	60
徑 方 向 Radius	A1	63	80	100	125	160	200	250
	A2	46	60	76	95	120	158	210
	A3	34.5	41.8	52	62	80	99.5	125
	C1	80	100	125	150	190	230	290
	C2	72	90	112	137	175	215	270
	C3	35	42	52	62	80	100	125
	V1	3-3.1	3-4.1	3-5.1	3-6.1	3-8.1	3-10.2	4-12.2
	V2	3-6.3	3-8	3-12	3-13	3-15	3-17.3	4-23
	V3	3-6	3-6	3-7.5	3-9.8	3-13	3-18	4-20.8
軸 方 向 Shaft	Y	5	6	7	7	9.5	9.5	11.5
	H	18	20	22	24	26	30	35
	J	3.5	4.3	5	5.5	6	7	8
	K	2	2.5	3	3.5	4	5	6
	L	22.05	24.8	27.9	31.3	35.5	42.2	48.6
	P	7.5	9.5	8.9	9	9.5	10.5	15.5
	X	1.5	1.4	1.7	2	2.5	5.7	6.4
	Z	6-60°						
a	0.2 (±0.05)			0.3 (+0.05/-0.1)		0.5 (-0/-0.2)		
重量 Weight (kg)		0.28	0.5	0.91	1.68	3.15	5.9	10.5
保護素子 Protective band		470KD07	GD80KD10		GD80KD14			

CDI Series

乾式單板超薄型電磁煞車器 Dry Single-plate Magnetic Brake

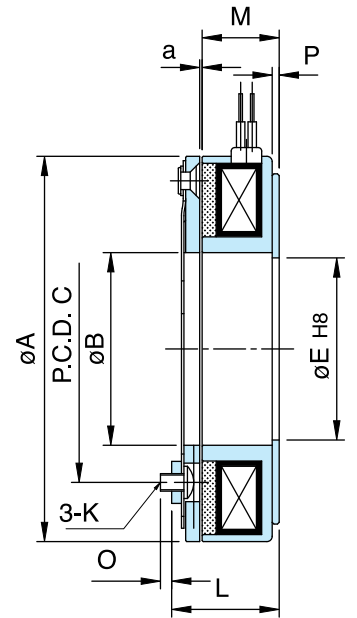
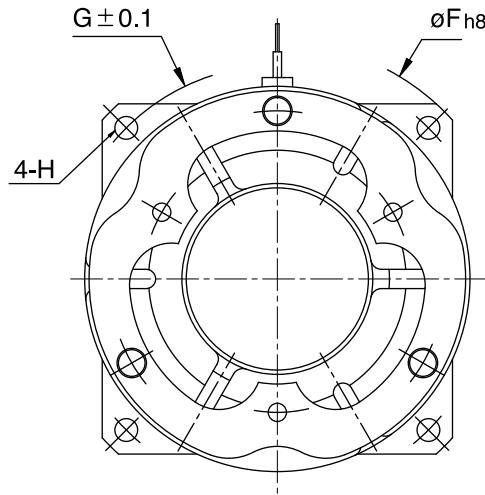

型號 MODEL	CDI0S6AA	CDI1S5AA	CDI2S5AA	CDI005AA	CDI010AA	CDI020AA	
靜摩擦轉距 [kgm](N-m) Static Friction Torque	0.55 (5.5)	1.1 (11)	2.2 (22)	4.5 (45)	9.0 (90)	17.5 (175)	
動摩擦轉距 [kgm](N-m) Dynamic Friction Torque	0.5 (5.0)	1.0 (10)	2.0 (20)	4.0 (40)	8.0 (80)	16 (160)	
功率 Power [24V](W) at 20°C	11	15	20	25	35	45	
徑方向 Radius	A	70	88	110	137	215	
	B	35	47	55	67	107	
	C	50	60	76	95	158	
	E	35	45	52	65	107	
	F	90	110	135	165	265	
	G	80	98	122	150	240	
	H	4.5	5.5	6.5	6.5	8.5	11
軸方向 Shaft	K	M3	M4	M5	M6	M10	
	L	25.2	27.75	29.9	36.7	47.4	
	M	19	20	21	26	31	
	O	5	6.15	8	11	17.5	
	P	2	2	2	2.5	3	3.2
	a	0.2 (±0.05)			0.3 (+0.05/-0.1)		0.5 (-0/-0.2)
重量 Weight (kg)	0.4	0.7	1.1	2.2	3.4	6.8	
保護素子 Protective band	470KD07	GD80KD10		GD80KD14			

CG1 Series

乾式單板電磁煞車器 Dry Single-plate Magnetic Brake

附導座 with plating hub

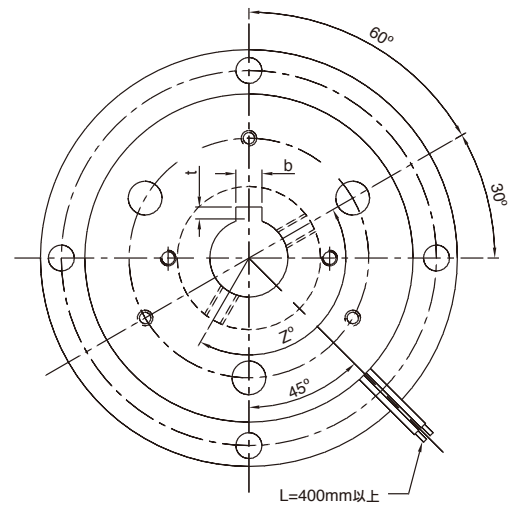
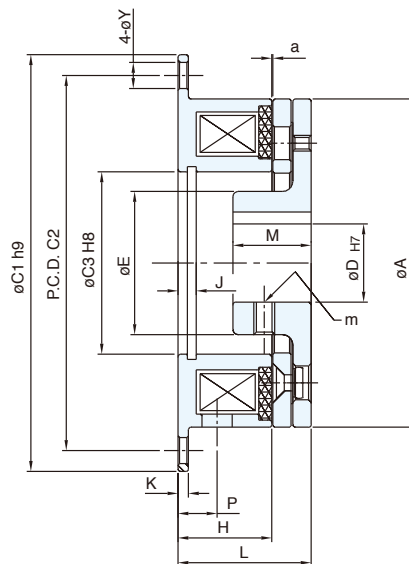

型號 MODEL		CG10S6AA(AB)	CG11S5AA(AB)	CG12S5AA(AB)	CG1005AA(AB)	CG1010AA(AB)	CG1020AA(AB)	CG1040AA(AB)	
靜摩擦轉距 Static Friction Torque [kgm](Nm)		0.55(5.5)	1.1 (11)	2.2 (22)	4.5(45)	9(90)	17.5(175)	35(350)	
動摩擦轉距 Dynamic Friction Torque [kgm](Nm)		0.5 (5.0)	1.0 (10)	2.0 (20)	4.0(40)	8(80)	16(160)	32(320)	
功率 Power [24V](W) at 20°C		11	15	20	25	35	45	60	
徑 方 向 Radius	A	63	80	100	125	160	200	250	
	C1	80	100	125	150	190	230	290	
	C2	72	90	112	137	175	215	270	
	C3	35	42	52	62	80	100	125	
	D	15 (12)	20 (15)	25 (20)	30 (25)	40 (30)	50 (40)	60 (50)	
	E	27.5	31	41	49	65	83	105	
軸 方 向 Shaft	H	18	20	22	24	26	30	35.1	
	J	3.5	4.3	5	5.5	6	7	8	
	K	2	2.5	3	3.5	4	5	6	
	L	25.55	28.8	32.9	37.3	42.5	50.5	59.6	
	M	15	20	25	30	38	45	54	
	P	7.5	9.5	8.9	9	11.5	9.5	15.5	
	Y	5	6	7	7	9.5	9.5	11.5	
	Z°	150°						120°	
	m	2-M4	2-M5	2-M6			2-M8		2-M10
	a	0.2 (±0.05)				0.3 (+0.05/-0.1)		0.5 (0/-0.2)	
	b	5 (4)	5 (5)	7 (5)	7(7)	10 (7)	12(10)	15(12)	
t	2.3(1.8)	2.3(2.3)	3.3(2.3)	3.3(3.3)	3.8 (3.3)	3.8(3.8)	5 (3.8)		
重量 Weight (kg)		0.32	0.58	1.07	1.97	3.45	7.1	12.2	
保護素子 Protective band		470KD07	GD80KD10			GD80KD14			

CG2 Series

乾式單板電磁煞車器 Dry Single-plate Magnetic Brake

附導座 with plating hub

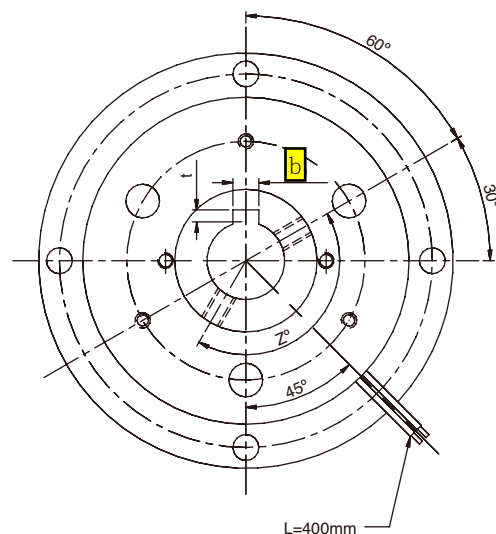
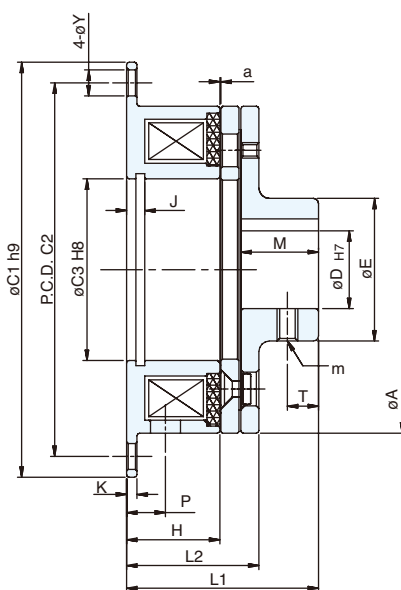

型號 MODEL	CG20S6AA(AB)	CG21S5AA(AB)	CG22S5AA(AB)	CG2005AA(AB)	CG2010AA(AB)	CG2020AA(AB)	CG2040AA(AB)	
靜摩擦轉距 Static Friction Torque [kgm](Nm)	0.55 (5.5)	1.1 (11)	2.2 (20)	4.5 (45)	9 (90)	17.5 (175)	35 (350)	
動摩擦轉距 Dynamic Friction Torque [kgm](Nm)	0.5 (5.0)	1.0 (10)	2.0 (22)	4.0 (40)	8 (80)	16 (160)	32 (320)	
功率 Power [24V](W) at 20°C	11	15	20	25	35	45	60	
徑 方 向 Radius	A	63	80	100	125	160	250	
	C1	80	100	125	150	190	290	
	C2	72	90	112	137	175	270	
	C3	35	42	52	62	80	100	
	D	15 (12)	20 (15)	25 (20)	30 (25)	40 (30)	50 (40)	60 (50)
	E	27.5	31	41	49	65	83	105
軸 方 向 Shaft	H	18	20	22	24	26	35	
	J	3.5	4.3	5	5.5	6	8	
	K	2	2.5	3	3.5	4	6	
	L1	37	44.8	53	61.3	73.5	102.6	
	L2	25.5	28.8	33	37.3	42.5	59.6	
	M	15	20	25	30	38	54	
	P	7.5	9.5	9	9	9.5	15.5	
	T	6	8	10	12	14	22	
	Y	5	6	7	7	9.5	11.5	
	Z°	150°			120°			
	m	2-M4	2-M5	2-M6		2-M8		2-M10
	a	0.2 (±0.05)			0.3 (^{+0.05} / _{-0.1})		0.5 (⁰ / _{-0.2})	
	b	5 (4)	5 (5)	7 (5)	7 (7)	10 (7)	12 (10)	15 (12)
t	2.3(1.8)	2.3 (2.3)	3.3(2.3)	3.3 (3.3)	3.8(3.3)	3.8(3.8)	5.3(3.8)	
重量 Weight (kg)	0.32	0.5	0.9	1.97	3.45	7.1	12.2	
保護素子 Protective band	470KD07	GD80KD10		GD80KD14				

CI1 Series

乾式單板超薄型電磁煞車器 Dry Single-plate Magnetic Brake

附導座 with plating hub

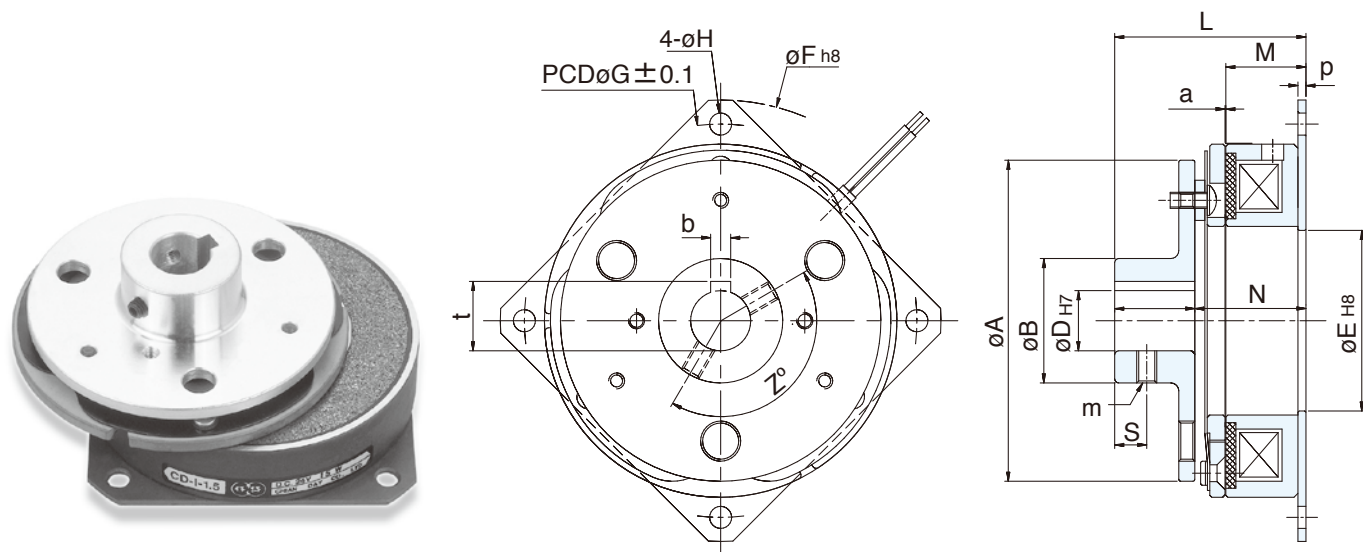

型號 MODEL		CI10S6AA(AB)	CI11S5AA(AB)	CI12S5AA(AB)	CI1005AA(AB)	CI1010AA(AB)	CI1020AA(AB)	
靜摩擦轉距 Static Friction Torque	[kgm](Nm)	0.55 (5.5)	1.1 (11)	2.2 (22)	4.5 (45)	9.0 (90)	17.5 (175)	
動摩擦轉距 Dynamic Friction Torque	[kgm](Nm)	0.5 (5.0)	1.0 (10)	2.0 (20)	4.0 (40)	8.0 (80)	16 (160)	
功率 Power	[24V](W) at 20°C	14	22	26	28.8	37	44	
徑 方 向 Radius	A	70	80	100	125	160	200	
	B	28	31	41	49	65	83	
	D	15 (12)	20 (15)	25 (20)	30 (25)	40 (30)	50 (40)	
	E	35	45	52	65	80	107	
	F	90	110	135	165	210	265	
	G	80	98	122	150	190	240	
	H	4.5	5.5	6.5	6.5	8.5	11	
軸 方 向 Shaft	L	39.3	47.75	54.9	65	78	92.4	
	M	18	20	21	26	27	31	
	N	25.7	27.75	29.9	36.7	40	47.4	
	O	15	20	25	30	38	45	
	P	2	2	2	2.5	3	3.2	
	S	6	8	10	12	14	18	
	m	M5	M5	M6	M6	M8	M10	
	a	0.2 (±0.05)			0.3 (^{+0.05} / _{-0.1})		0.5 (⁰ / _{-0.2})	
	b	5(4)	5	7(5)	7	10(7)	12(10)	
	t	17.3(13.8)	22.3(17.3)	28.3(22.3)	33.3(28.3)	43.8(33.3)	53.8(43.8)	
	Z°	150°						120°
重量 Weight	(kg)	0.5	0.7	1.3	2.5	4.2	8	
保護素子 Protective band		470KD07	GD80KD10		GD80KD14			

CI2 Series

乾式單板超薄型電磁煞車器 Dry Single-plate Magnetic Brake

附導座 with plating hub

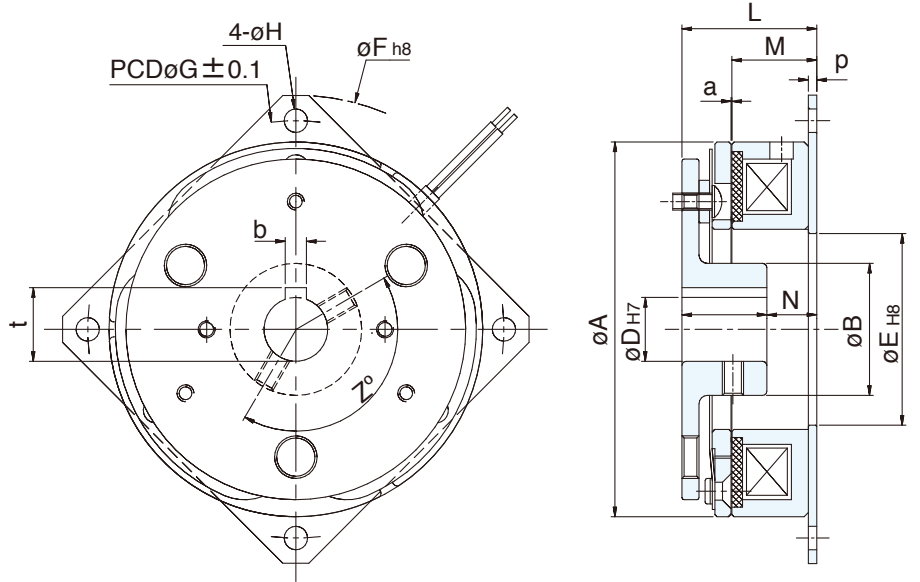

型號 MODEL		CI21S5AA(AB)	CI22S5AA(AB)	CI2005AA(AB)	CI2010AA(AB)	CI2020AA(AB)
靜摩擦轉距 Static Friction Torque	[kgm](Nm)	1.1 (11)	2.2 (22)	4.5 (45)	9.0 (90)	17.5 (175)
動摩擦轉距 Dynamic Friction Torque	[kgm](Nm)	1.0 (10)	2.0 (20)	4.0 (40)	8.0 (80)	16 (160)
功率 Power	[24V](W) at 20°C	22	26	29	37	44
徑 方 向 Radius	A	88	110	137	172	215
	B	31	41	49	65	83
	D	20 (15)	25 (20)	30 (25)	40 (30)	50 (40)
	E	45	52	65	80	107
	F	110	135	165	210	265
	G	98	122	150	190	240
	H	5.5	6.5	6.5	8.5	11
軸 方 向 Shaft	L	31.75	34.9	42.7	47	56.4
	M	20	21	26	27	31
	N	11.75	9.9	12.7	9	11.4
	O	20	25	30	38	45
	P	2	2	2.5	3	3.2
	a	0.2 (\pm 0.05)		0.3 ($^{+0.05}_{-0.1}$)		0.5 ($^{0}_{-0.2}$)
	b	5	7(5)	7	10(7)	12(10)
	t	22.3(17.3)	28.3(22.3)	33.2(28.3)	43.8(33.3)	53.8(43.8)
	Z°	150°				
重量 Weight	(kg)	0.7	1.3	2.5	4.2	8
保護素子 Protective band		GD80KD10			GD80KD14	

MG1 Series

微小型電磁煞車器 Micro Magnetic Brake 附導座 with plating hub

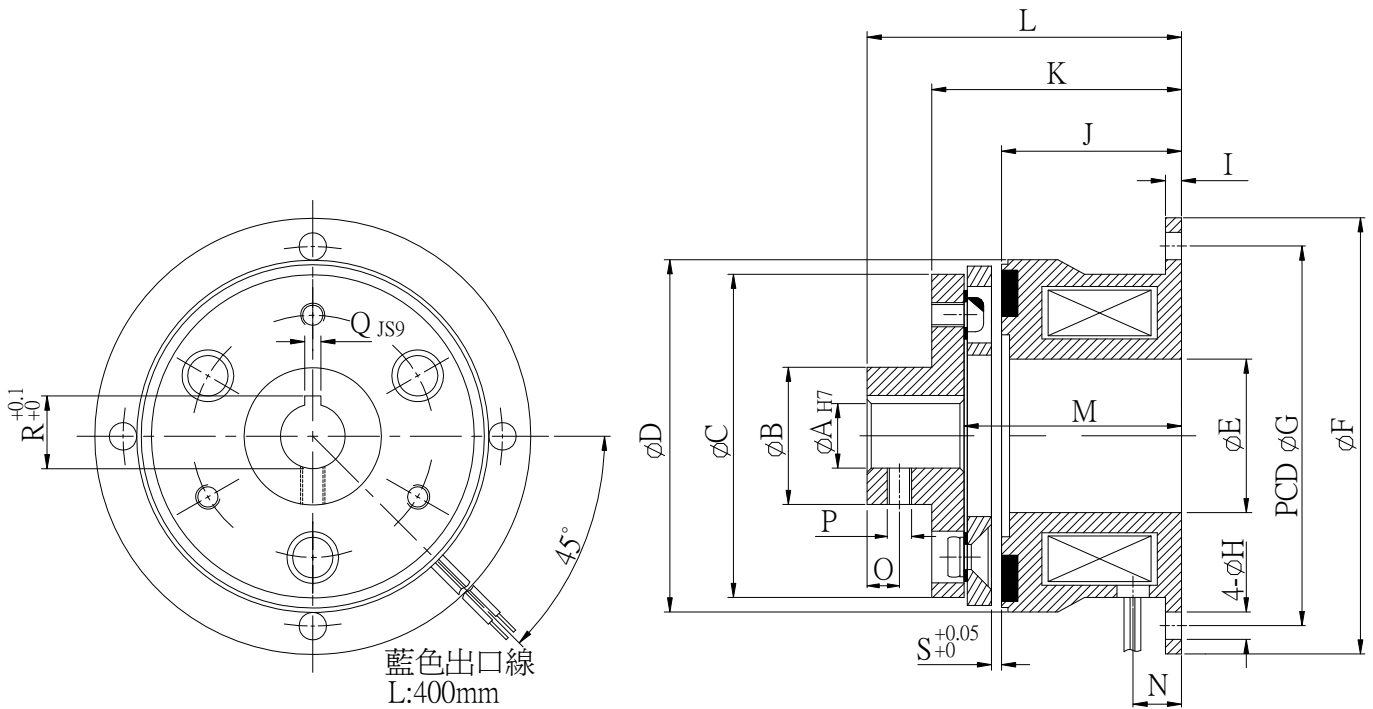

型號 MODEL	MG1S06AA	MG1S09AA	MG10S2AA	MG10S4AA	
靜摩擦轉距 (Nm)	0.6	0.9	2.2	4.5	
功率 [24V](W) at 20°C	6.2	6	8	10	
徑向尺寸	A	6	6	8	10
	B	12.9	15	17	24
	C	28	32	40	50
	D	31	34	43.6	54.5
	E	11	13	19	26
	F	39	45	54	65
	G	33.5	38	47	58
	H	3.4	3.4	3.4	3.4
軸向尺寸	I	1.5	2	2	2
	J	16	18.9	22.3	23.5
	K	21.3	24.4	28.4	29.7
	L	26.3	31.4	37.4	38.7
	M	18.3	21.4	25.4	26.7
	N	4	5	6	6
	O	2.5	4	4	5
	P	M3*P0.5	M3*P0.5	M3*P0.5	M3*P0.5
	Q	2	2	2	3
	R	7	7	9	11.4
	S	0.1	0.1	0.15	0.2

MBG Series

微小型電磁煞車器 Micro Magnetic Brake

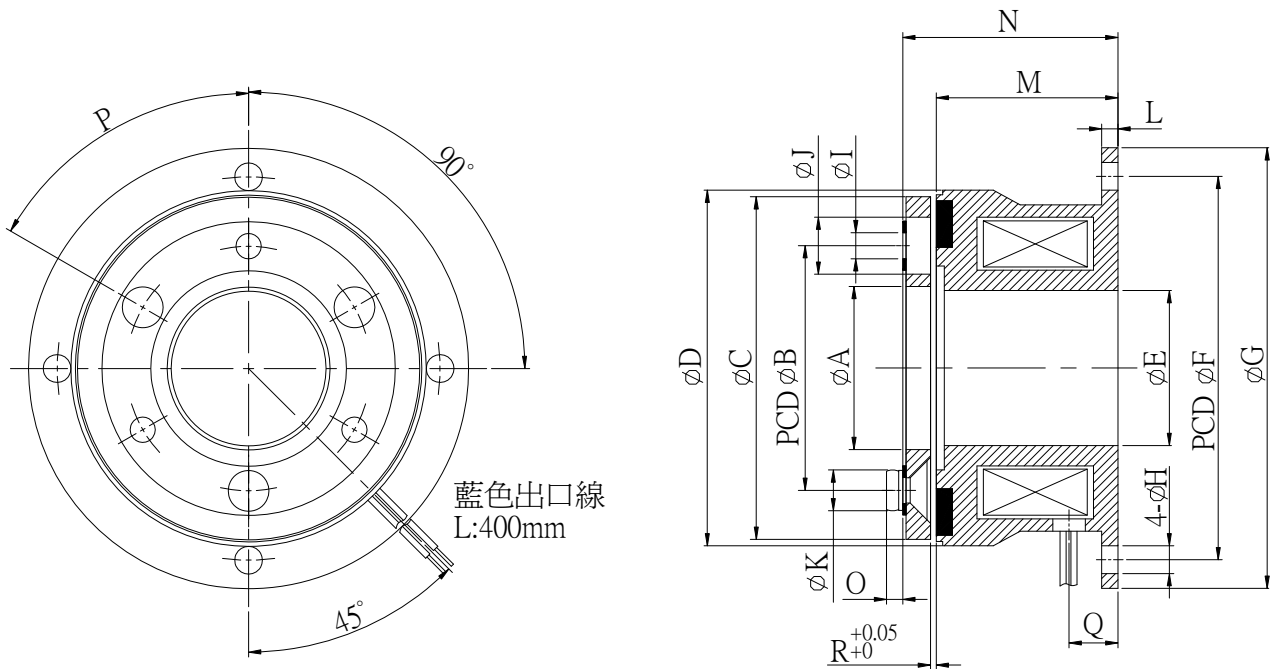

型號 MODEL	MBGS06AA	MBGS09AA	MBG0S2AA	MBG0S4AA	
靜摩擦轉距 (Nm)	0.6	0.9	2.2	4.5	
功率 [24V](W) at 20°C	6.2	6	8	10	
徑向尺寸	A	12.6	15.2	21.2	29
	B	19.5	23	30	38
	C	31	34	43	54
	D	31.9	34.2	43.6	54.5
	E	11	13	19	26
	F	33.5	38	47	58
	G	39	45	54	65
	H	3.4	3.4	3.4	3.4
	I	2-2.1	3-2.6	3-3.1	3-3.1
	J	2-5	3-6	3-6.5	3-6.5
軸向尺寸	K	2-3.8	3-4.5	3-5	3-5
	L	1.5	2	2	2
	M	16	18.9	22.3	23.5
	N	18.3	21.4	25.4	26.7
	O	1.2	1.5	1.4	1.8
	P	90°	60°	60°	60°
	Q	4	5	6	6
R	0.1	0.1	0.15	0.2	